



Alba Home Sirmione srl Piazza Unità D'Italia 4 25019 Sirmione (BS) Tel 0309905560 - Cel 3911415140 info@albahome.it www.albaluxury.it



## Flat Sale in Dubai (DU) Mercedes benz - Binghatti

### Mercedes-Benz Places is a collaboration Binghatti

For information, prices per type, floor plan and payment plans, please contact us.

Mercedes-Benz Places is a collaboration between Binghatti Developers and luxury automotive giant Mercedes-Benz in Downtown Dubai, featuring luxury 2-, 3-, and 4-bedroom apartments and penthouses. This iconic residence, rising majestically to a height of 341 meters over 65 floors, is set to redefine the opulence of Downtown Dubai's skyline. With an unwavering commitment to fusing automotive excellence and architectural grandeur, the project symbolizes a unique fusion of real estate and automotive brilliance.

Premium brand collection of 2-, 3- and 4-bedroom apartments and penthouses with remarkable floor-to-ceiling heights.

It rises to a height of 341 meters and spans 65 stories like a beacon of architectural grandeur.

Located in the heart of downtown Dubai, surrounded by iconic structures such as the Dubai Mall and the Museum of the Future.

Elevating the concept of exclusivity, each residence in this luxurious complex features a private pool.

Strategically positioned, all units offer residents panoramic views of the iconic Burj Khalifa, creating a living experience with exclusive appeal.

Guided by the Mercedes-Benz design philosophy of "sensual purity," they create a harmonious oasis of serenity and aesthetic appeal.

#### INFORMATION

Ref.	Dubai 024
Type	Sale
Category	Flat
Price	2,800,000.00
Annual Expense	
Year	
Energetic Class	A4 12.12

#### NUMBER

Rooms	3
Bedrooms	2
Bathrooms	2
Balconies + Terraces	1
Floor	
Car Space	
Box	

#### SQUARE METERS

Commercial	252
Garden	
Cellar	
Balconies + Terraces	51
Attic	
Tavern	
Box	

### FEATURES

Property Conditions	New	Rank	Elegant	Position	See
View	Sea View	Orientation	North West South East	Garden	Common
Furniture	Possibility	Type living	Living room	Type of heating system	Air heating



Alba Home Sirmione srl Piazza Unità D'Italia 4 25019 Sirmione (BS) Tel 0309905560 - Cel 3911415140 info@albahome.it www.albaluxury.it

Floors Living Room **Marble**

Floors Bedrooms **Marble**

Floors Kitchen **Marble**

Floors Bathroom **Marble**

## ACCESSORIES

Antitheft

Air conditioning

Double glazing

Swimming pool

Data network

## IMAGES

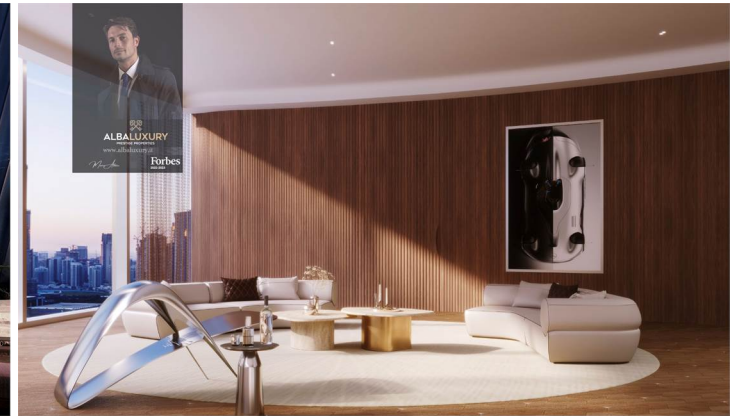
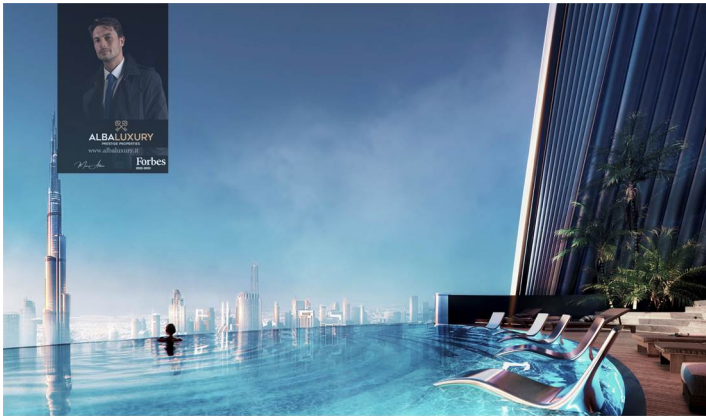
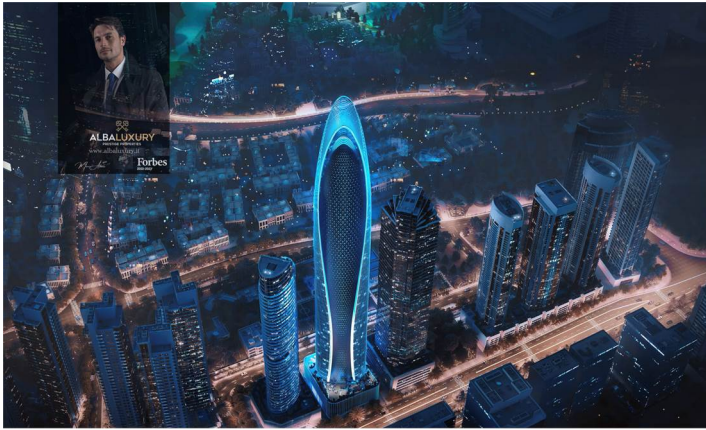





Alba Home Sirmione srl Piazza Unità D'Italia 4 25019 Sirmione (BS) Tel 0309905560 - Cel 3911415140 info@albahome.it www.albaluxury.it

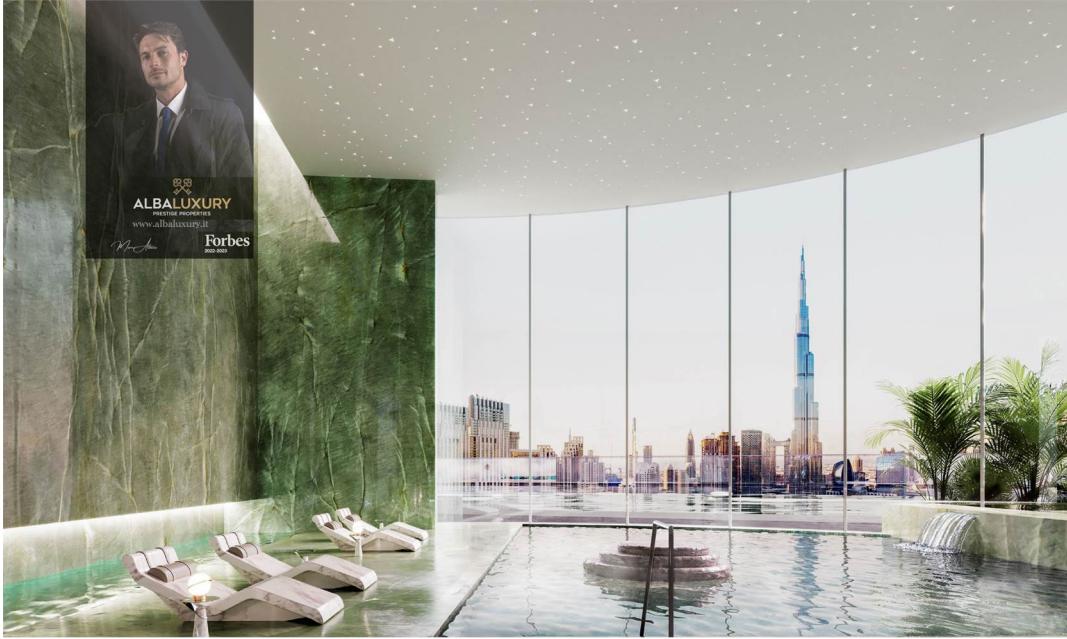

## The Mercedes-Benz Pagoda Suite

NUMBER OF UNITS  
**80**

2 Bedroom Unit

Named after the renowned Mercedes-Benz Pagoda, a symbol of a craftsmanship that is both bold and humble in its nature.



## The Grand Mercedes Suite

NUMBER OF UNITS  
**57**

3 Bedroom Unit



## The Mercedes-Benz Vision One-Eleven Penthouse

NUMBER OF UNITS  
**8**

4 Bedroom Unit

Named after the one and only Mercedes-Benz Vision One-Eleven; iconic, legendary, and indisputably game-changing.







Alba Home Sirmione srl Piazza Unità D'Italia 4 25019 Sirmione (BS) Tel 0309905560 - Cel 3911415140 info@albahome.it www.albaluxury.it

### The Mercedes-Benz Gullwing Penthouse

5 Bedroom Penthouse

Named after the memorable Mercedes-Benz 300 SL Gullwing, the 5-bedroom penthouse manifests the same pre-eminent experience of the acclaimed automobile.

**NUMBER OF UNITS**  
3



### The Mercedes-Benz Vision EQ Silver Arrow Penthouse

The Duplex Penthouse

Named after the groundbreaking Mercedes-Benz Vision EQ Silver Arrow, the Duplex Penthouse echoes the same exciting moments of this legend.

**NUMBER OF UNITS**  
1



### The Mercedes-Benz Uhlenhaut Coupé Penthouse

The Triplex Penthouse

Remarkable. Exceptional. Sensational. In a tribute to the most valuable car in history, the Triplex Penthouse at the height of the hyper-tower pays homage to the legendary automobile by creating an inexplicable experience of living.

**NUMBER OF UNITS**  
1



#### TYPICAL FLOOR PLAN-TYPE 01

RESIDENTIAL FLOOR 01 TO 20

LEVELS 12-31

**UNITS TYPE | NUMBER**  
2-BEDROOM | 4

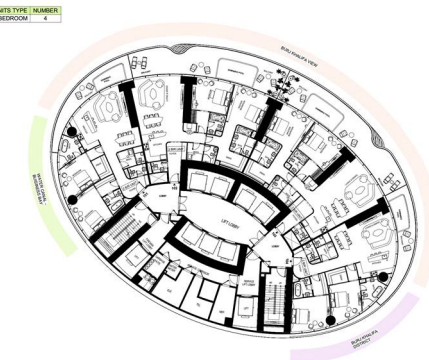

**VIEW ANALYSIS**

- 01 BUREAU DISTRICT - BUREAU DISTRICT
- 02 BUREAU DISTRICT
- 03 WATER CANAL - BUSINESS BAY

**COMMON SPECIFICATIONS**

**CONSTRUCTION:** Theophile Stone or equivalent

**GLASS CURTAIN:** Theophile Stone or equivalent

**GLASS CURTAIN:** Theophile Stone or equivalent (Double Panel / Thermal Break / Chrome frame)

**INTERIOR:** Composite flooring

**SMART SYSTEM SPECIFICATIONS**

**ACUSTIC SPECIFICATIONS**

**EXTRA FEATURES**

#### TYPICAL FLOOR PLAN-TYPE 02

RESIDENTIAL FLOOR 21 TO 34

LEVELS 34-42

**UNITS TYPE | NUMBER**  
3-BEDROOM | 3



**VIEW ANALYSIS**

- 01 BUREAU DISTRICT - BUREAU DISTRICT
- 02 BUREAU DISTRICT
- 03 WATER CANAL - BUSINESS BAY

**COMMON SPECIFICATIONS**

**CONSTRUCTION:** Theophile Stone or equivalent

**GLASS CURTAIN:** Theophile Stone or equivalent

**GLASS CURTAIN:** Theophile Stone or equivalent (Double Panel / Thermal Break / Chrome frame)

**INTERIOR:** Composite flooring

**SMART SYSTEM SPECIFICATIONS**

**ACUSTIC SPECIFICATIONS**

**EXTRA FEATURES**

#### TYPICAL FLOOR PLAN-TYPE 03 A

RESIDENTIAL FLOOR 40

LEVEL 55

**UNITS TYPE | NUMBER**  
4-BEDROOM | 2



**VIEW ANALYSIS**

- 01 BUREAU DISTRICT - BUREAU DISTRICT
- 02 BUREAU DISTRICT
- 03 WATER CANAL - BUSINESS BAY

**COMMON SPECIFICATIONS**

**CONSTRUCTION:** Theophile Stone or equivalent

**GLASS CURTAIN:** Theophile Stone or equivalent

**GLASS CURTAIN:** Theophile Stone or equivalent (Double Panel / Thermal Break / Chrome frame)

**INTERIOR:** Composite flooring

**SMART SYSTEM SPECIFICATIONS**

**ACUSTIC SPECIFICATIONS**

**EXTRA FEATURES**

#### TYPICAL FLOOR PLAN-TYPE 03C

RESIDENTIAL FLOOR 42

LEVEL 57

**UNITS TYPE | NUMBER**  
4-BEDROOM | 2

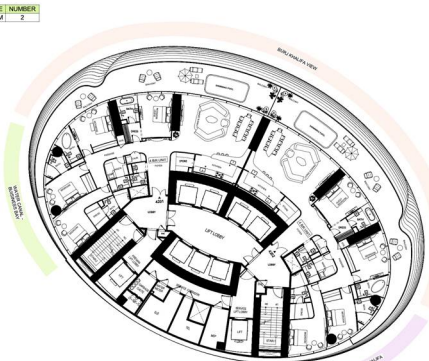

**VIEW ANALYSIS**

- 01 BUREAU DISTRICT - BUREAU DISTRICT
- 02 BUREAU DISTRICT
- 03 WATER CANAL - BUSINESS BAY

**COMMON SPECIFICATIONS**

**CONSTRUCTION:** Theophile Stone or equivalent

**GLASS CURTAIN:** Theophile Stone or equivalent

**GLASS CURTAIN:** Theophile Stone or equivalent (Double Panel / Thermal Break / Chrome frame)

**INTERIOR:** Composite flooring

**SMART SYSTEM SPECIFICATIONS**

**ACUSTIC SPECIFICATIONS**

**EXTRA FEATURES**

#### TYPICAL FLOOR PLAN-TYPE 04

RESIDENTIAL FLOOR 45

LEVEL 60

**UNITS TYPE | NUMBER**  
5-BEDROOM | 1



**VIEW ANALYSIS**

- 01 BUREAU DISTRICT - BUREAU DISTRICT
- 02 BUREAU DISTRICT
- 03 WATER CANAL - BUSINESS BAY

**COMMON SPECIFICATIONS**

**CONSTRUCTION:** Theophile Stone or equivalent

**GLASS CURTAIN:** Theophile Stone or equivalent

**GLASS CURTAIN:** Theophile Stone or equivalent (Double Panel / Thermal Break / Chrome frame)

**INTERIOR:** Composite flooring

**SMART SYSTEM SPECIFICATIONS**

**ACUSTIC SPECIFICATIONS**

**EXTRA FEATURES**